

PROGEF Standard reducer S5/SDR11

Model:

- Material: PP-H
- Conventional butt-welding according to DVS 2207
- IR = Infrared-(IR Plus®) compatible. Choose fusion parameters: PP-H

¹ Material:PP-R

	d	d1	FM	Code	Weight	e	e1	L	L1	L2
	(mm)	(mm)			(kg)	(mm)	(mm)	(mm)	(mm)	(mm)
	25	20	IR	727 908 537	0.007	2.3	1.9	50	20	20
	32	20	IR	727 908 542	0.010	2.9	1.9	50	20	20
	32	25	IR	727 908 541	0.010	2.9	2.3	50	20	20
	40	20	IR	727 908 548	0.016	3.7	1.9	58	20	23
	40	25	IR	727 908 547	0.016	3.7	2.3	55	20	20
	40	32	IR	727 908 546	0.018	3.7	2.9	55	20	20
	50	25	IR	727 908 554	0.024	4.6	2.3	60	20	20
	50	32	IR	727 908 553	0.027	4.6	2.9	60	20	20
	50	40	IR	727 908 552	0.030	4.6	3.7	60	20	20
	63	32	IR	727 908 560	0.043	5.8	2.9	65	20	20
	63	40	IR	727 908 559	0.047	5.8	3.7	65	20	20
	63	50	IR	727 908 558	0.051	5.8	4.6	65	20	20
	75	40	IR	727 908 566	0.062	6.8	3.7	68	20	20
	75	50	IR	727 908 565	0.071	6.8	4.6	65	20	20
	75	63	IR	727 908 564	0.075	6.8	5.8	65	20	20
	90	63	IR	727 908 571	0.115	8.2	5.8	75	22	19
	90	75	IR	727 908 570	0.130	8.2	6.8	75	22	19
	110	63	IR	727 908 572	0.201	10.6	6.2	90	28	28
	110	75	IR	727 908 577	0.215	10.0	6.8	90	28	18
	110	90	IR	727 908 576	0.225	10.0	8.2	90	28	30
	125	110	IR	727 908 580	0.335	11.4	10.0	100	32	30
	140	110	IR	727 908 585	0.423	12.7	10.0	110	33	29
	140	125	IR	727 908 584	0.462	12.7	11.4	110	34	30
	160	110	IR	727 908 590	0.586	14.6	10.0	120	39	27
	160	140	IR	727 908 588	0.647	14.6	12.7	120	40	35
	180	90	IR	727 908 149	0.800	16.4	8.8	145	50	40
	180	110	IR	727 908 150	1.010	16.4	10.0	150	50	40
	180	125	IR	727 908 151	0.985	16.4	11.4	145	52	40
	180	140	IR	727 908 152	0.995	16.4	12.7	135	51	47
	180	160	IR	727 908 153	1.020	16.4	14.6	135	55	52
	200	160	IR	727 908 592	1.149	18.2	14.6	145	50	40
	200	180	IR	727 908 158	1.300	18.2	16.4	145	50	45
	225	110	IR	727 908 595	1.485	20.5	10.0	160	55	35
	225	160	IR	727 908 596	1.563	20.5	14.6	160	55	40
	225	180	IR	727 908 162	1.770	20.5	16.4	163	60	58
	225	200	IR	727 908 597	1.723	20.5	18.2	160	55	50
	250	160		727 908 165	2.140	22.7	14.6	170	63	53
	250	225		727 908 168	2.750	22.7	20.5	180	65	65
1	280	225		727 908 172	3.425	25.4	20.5	203	72	57
1	280	250		727 908 173	1.980	25.4	22.7	206	75	60
1	315	225		727 908 176	5.110	28.6	20.5	237	84	60
1	315	250		727 908 177	5.105	28.6	22.7	231	86	63
1	315	280		727 908 178	5.130	28.6	25.4	222	80	70
1	355	250		727 908 963	5.490	32.3	22.7	245	90	60
1	355	280		727 908 962	5.462	32.2	25.4	245	90	70
1	355	315		727 908 961	3.700	32.2	28.6	245	90	80
1	400	315		727 908 966	5.300	36.3	28.6	260	95	80
1	400	355		727 908 965	4.800	36.3	32.2	260	95	90
	450	280		727 908 960	9.000	40.9	25.4	230	60	70
	450	315		727 908 948	8.000	40.9	28.6	230	60	80
	450	355		727 908 950	7.400	40.9	32.2	230	60	90

Data sheet

valid from: 2/13/17

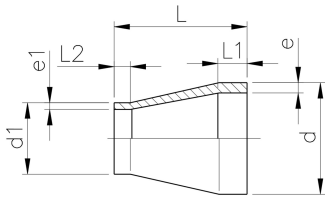

d (mm)	d1 (mm)	FM	Code	Weight (kg)	e (mm)	e1 (mm)	L (mm)	L1 (mm)	L2 (mm)
450	400		727 908 951	6.000	40.9	36.3	230	60	95
500	315		727 908 953	12.000	45.4	28.6	230	60	80
500	355		727 908 954	10.800	45.4	32.2	230	60	90
500	400		727 908 956	10.000	45.4	36.3	230	60	95
500	450		727 908 964	8.300	45.4	40.9	230	60	60

The technical data are not binding. They neither constitute expressly warranted characteristics nor guaranteed properties nor a guaranteed durability. They are subject to modification. Our General Terms of Sale apply.

Georg Fischer Piping Systems Ltd, Postfach, CH-8201 Schaffhausen/Switzerland

Phone +41 -(0)52-631 1111

e-mail: info.ps@georgfischer.com

Internet: <http://www.gfps.com>